

Welcome, BEYONDSM

MORE SPACE. MORE LUXURY. MORE CONNECTED.
Celebrity BeyondSM, the next Edge[®] Series ship, sails April 2022.



CELEBRITY BEYOND FAST FACTS

Inaugural date: APRIL 2022
Ship's registry: Malta

Designed entirely
in 3-D

TONNAGE	LENGTH	BEAM	DRAUGHT	CRUISING SPEED	CREW	STATEROOMS	GUESTS
140,600	1,073 ft	128 ft	27 ft	21.8 kts	1400+ from 60 Countries	1,646	3,260

HOW WE MADE EXTRAORDINARY EVEN BETTER

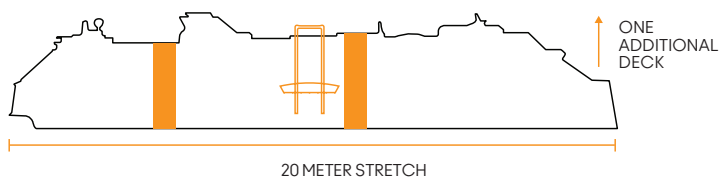

- Longer, taller, sleeker profile
- 179 more suites and staterooms
- More of The Retreat[®] with a 40% larger sundeck
- More Resort Deck with expanded open-air spaces
- More restaurants, bars, and lounges to enjoy
- Now 17 decks
- Sunset Bar 180% larger



All Suites. All Exclusive. All Included.

The Retreat[®] has been taken to another level with an expanded two-story sundeck and stunningly redesigned exclusive spaces that are all adjacent to create a true resort-within-a-resort.



TRANSFORMATIONAL ACCOMMODATIONS

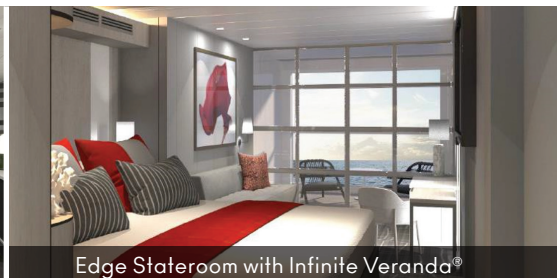
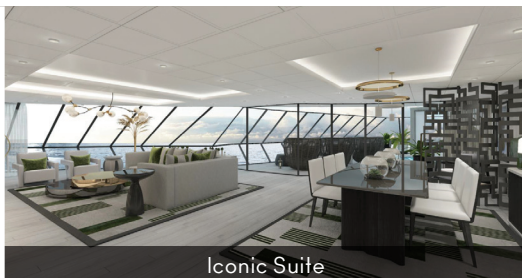

- Two-story suites
- Private plunge pool
- Direct access to The Retreat Sundeck

- Largest suites in the fleet
- A view as good as the Captain's

- 23% larger than Solstice[®] Series veranda staterooms
- Entire living space becomes the veranda
- King-sized Cashmere[™] Mattress featuring Celebrity's eXhale[®] bedding



Wellness is so fundamental to our philosophy, we've created a whole new way to nourish your mind, body, and spirit. Introducing AquaClass[®] Sky Suites, which combine the best of our AquaClass stateroom experiences with the luxurious spaces, services, and amenities of The Retreat[®].



Le Voyage

World renowned chef Daniel Boulud, our Global Culinary Ambassador, has created his first signature restaurant at sea. The globally inspired flavors he has infused into his menu will transport you to the very places that inspired them.



SUNSET BAR

The ocean is one of the most rejuvenating places you can be, and the talented Nate Berkus took advantage of this to create a redesigned, terraced Sunset Bar that's nearly twice the size.

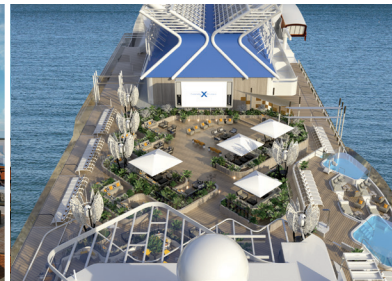

ROOFTOP GARDEN

With cantilevered float pools that extend over the water's edge, our reimagined Rooftop Garden is a stunning collaboration between designer Kelly Hoppen, CBE, and architect Tom Wright, of WKK.



Grand Plaza

Design firm Jouin Manku has made the social epicenter of the ship even more dramatic than before with a new, organic shape, LED chandelier, and redesigned Martini Bar.



Resort Deck

The larger outward-facing pool deck means you never have to take your eyes off the ocean while you get your vitamin D. Kelly Hoppen's new design and the vision of architect Tom Wright make the Resort Deck the ultimate sun-soaked destination.



MAGIC CARPET

No rush can compete with the endless views 15 decks above the sea on our cantilevered Magic Carpet[®]. Float across the horizon as you drink, dine, or simply relax on this feat of engineering that transforms into different experiences.



EDEN

Chillful. Playful. Wonderful.

Awaken all your senses in this three-story venue wrapped in panoramic views, featuring daytime activities, Wonder at Eden thematic experiences each night, Eden Bar, Eden Café, and our delicious Eden Restaurant.



spa

Escape to a luxurious sanctuary for the modern traveler with our SEA Thermal Suite and ahh-inspiring new firsts, like an expanded Fitness Center with F45 fitness classes, our Women in Wellness program, and new treatment tables.